

TREGO

DOWEL PULLER

*For a fast and simple way to remove
dowels in cylinderblocks and heads
etc. "Easy to change" insert collets
for dowel dimensions 3-20 mm*



Standard set includes:

6 mm	1/4"
8 mm	11/32"
10 mm	3/8"
12 mm	7/16"
14 mm	1/2"



TREGO MASKIN AB

TREGO DOWEL PULLER

Dowel Puller: **How to use**

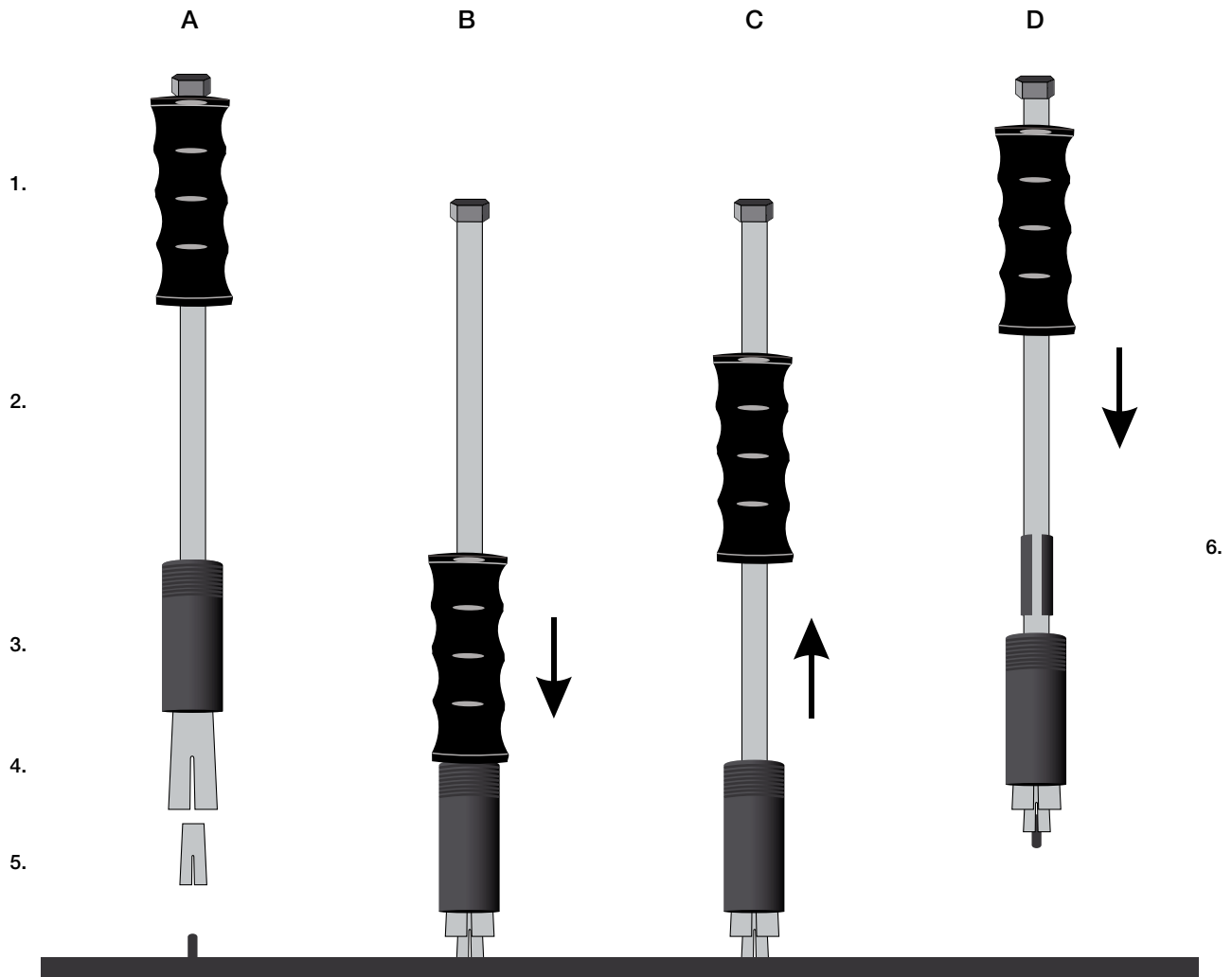

1. Hammer
2. Rod
3. Sleeve
4. Collet
5. Insert Collet
6. Opener

- A. Put a suitable insert collet on the dowel. Place the complete tool over the insert collet
- B. Hit the sleeve with the hammer until the collet together with the insert collet will grip the dowel sufficiently

- C. Hit with the hammer upwards until the dowel gets loose.
- D. Attach the opener and hit the hammer until the dowel falls out.



TREGO MASKIN AB

RATTGATAN 6, SE-827 35 LJUSDAL, SWEDEN • TEL: +46 651 124 60
INFO@TREGOMASKIN.SE • WWW.TREGOMASKIN.SE

Distributed by: